

| | |
|------------------|----------------------------|
| MATERIAL: | 16 GA A60 GALV |
| HINGE PREP: | 4-1/2" STD WT |
| STRIKE PREP: | ASA |
| STD JAMB SIZES*: | 4-3/4, 5-5/8, 5-7/8, 7-1/8 |

*MOST COMMON JAMB DEPTH: 5-7/8
 DEDUCT 1.00 INCH FOR THROAT DEPTH
 OTHER SIZES MAY BE AVAILABLE

DRYWALL RETURN BEND (TYP)

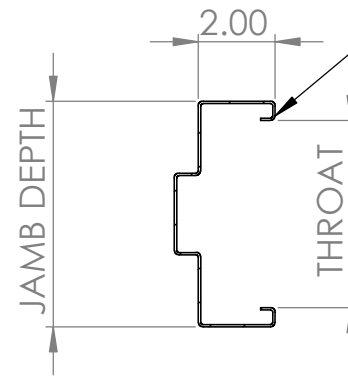

JAMB & HEADER PROFILE

3-PIECE SLIP-ON FRAME

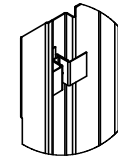
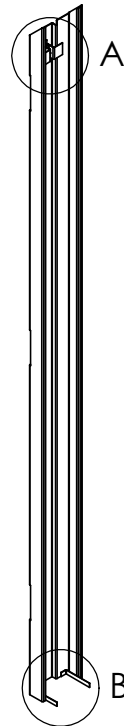
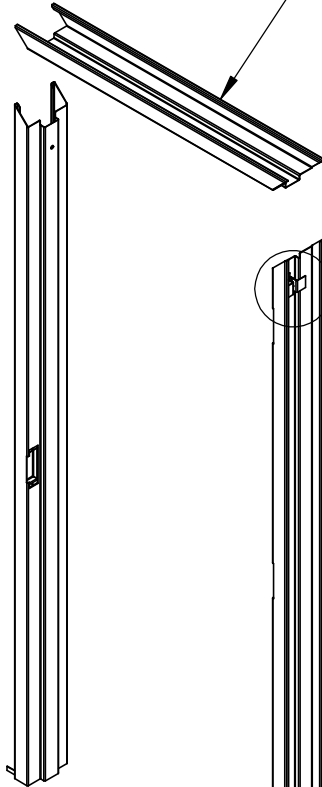
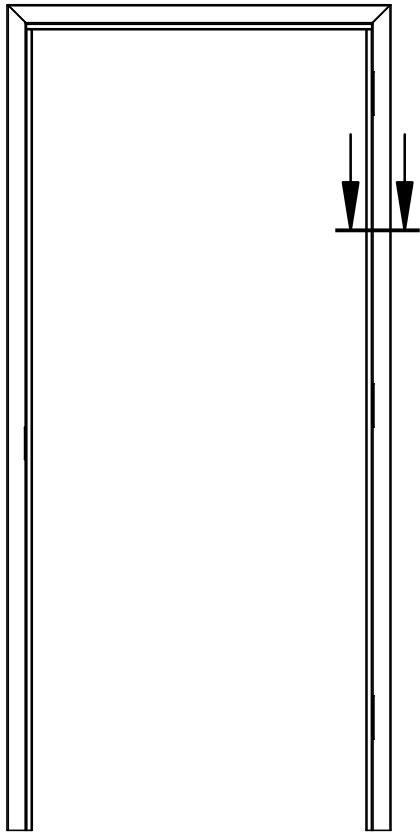
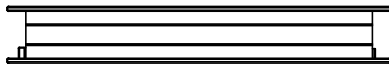

DRYWALL PRESSURE ANCHORS (EA SIDE)

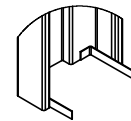

DRYWALL STRAP ANCHORS (EA SIDE)

ROUGH OPENING SIZE: 2" WIDER & 1" HIGHER THAN NOMINAL DOOR SIZE



Somerset NJ | 908-758-2400
 www.thenewportco.com

STANDARD DRAWINGS

TYPICAL DRYWALL FRAME

PROJECT NAME:

DESCRIPTION:

PROJECT #

NA

DATE

NA

DWG #

FD-02